



尚健維佳

Celki VitalAire

家居醫療服務



# 維健 REGAIN

## 家居機械通氣治療

Home Mechanical Ventilation  
Supporting Program



你需要的遠不止於一部儀器，而是全面的解決方案  
What you need is not only a device, but a Solution

# 簡介 Introduction

隨著過去科技進步與服務流程改革，機械通氣治療日趨普及，促成了「家居機械通氣治療」的誕生。

家居機械通氣治療，泛指病患在居所中透過配戴面罩(無創)或氣管插喉(有創)兩種方式，間歇或持續使用醫療儀器作通氣治療。其中尤以無創形式最為普遍，新機種透過高效漏氣補償，讓治療效果得以保障。

療程的成效，取決於病患能否將使用儀器的習慣持之以恆，由入院時的危急狀態順利過渡至穩定階段，並於出院後維持家居療養。過程中，病患、醫院、家居醫療服務供應商之間的緊密配合，可謂不可或缺。

憑藉三十多年服務呼吸科病患經驗，尚健維佳能配合不同需要，提供對應的醫療器材及服務。當中包括：家居機械通氣治療、氧氣療養、抽痰機、遙距監察病患等。透過長久以來與不同醫療機關合作，我們建立出一套專業培訓系統，肩負起家居醫療服務供應商的應有責任。

「**維健 Regain**」是一套行之有效的家居機械通氣治療方案，這套全面方案涵蓋不同治療階段，由深切治療部/呼吸科病房緊急治療作起點，拓展至呼吸科或內科病房，進而從出院途中，延續至出院後的家居療養。在不同階段中，為病患提供全面的支援、教育及監察服務。

Mechanical ventilation has been widely applied over the past 30 years due to technology advancements and protocol upgrades. Hence, it has led to an emergence of Home Mechanical Ventilation (HMV).

HMV is defined as an intermittent or continuous use of an HMV device through a mask interface (non-invasive) or a tracheostomy tube (invasive) at home. The Non-Invasive Ventilation (NIV) is most commonly used nowadays after the introduction of effective compensation for air leaks.

A successful application of HMV relies critically on the continuum of use and smooth transition from acute to subacute phase in hospital to home after discharge. It requires seamless coordination between medical professionals in hospital and the homecare provider at home.

Celki VitalAire, with over 30 years of experience of serving patients with respiratory diseases, has all the peripheral services and equipment required to meet different needs, such as HMV, oxygen, suction and tele-monitoring to patients. We are experienced and professional at hospital ventilators in particular.

**REGAIN** is a program providing an All-rounded Home Mechanical Ventilation (HMV) solution to patients. The chain service starts from the ICU, to the respiratory or medical ward, and finally at home after the patient is discharged.

## 緊急階段

### 緊急階段 Acute Phase

- 深切治療部 ICU
- 呼吸科病房 Respiratory Ward

儀器 Equipment:



SV70

### 穩定階段時的滴定測試 / 留院治療 Titration/Adaptation in a Sub-acute Phase

## 穩定階段

- 呼吸科病房 Respiratory Ward
- 內科病房 Medical Ward

儀器 Equipment:



Trilogy EVO



Trilogy 100



EO-150



Prisma Vent40



A40 Pro

## 家居療養

### 家居療養 Home Treatment

儀器 Equipment:



Trilogy EVO



EO-150



Prisma Vent40



Lumis 150



Trilogy 100



A40 Pro



Prisma 30ST



DreamStation BiPAP ST



# 全面治療方案

## All-rounded HMV solution

作為負責任的家居醫療服務供應商，尚健維佳致力於兩大原則：  
At Celki VitalAire, being a responsible home healthcare service provider, our primary goals are:

1 維持及提昇患者生活質素  
To maintain and enhance the quality of life of patients

2 增加患者存活率  
To improve the life expectancy

「維持生活質素  
關注您的健康」  
Rely on us Regain your Health

「維健」  
家居機械通氣治療計劃  
為患者及家屬提供全面服務，  
讓他們在醫護人員處方下，  
儘快 恢復呼吸功能。

“REGAIN”  
Our Home Mechanical Ventilation  
Supporting Program with  
comprehensive services to patients  
in order to help them REGAIN their  
respiratory function based on  
physician's prescriptions.

- 指導患者及家屬正確使用器材  
Advise patients and their family members to use the devices correctly
- 協助患者及家屬依從醫護人員處方  
Advise patients and their family members to follow physician's prescriptions

- 透過家訪及持續跟進工作，使患者有效地進行家居機械通氣治療  
Benefit from an effective home mechanical ventilation treatment upon home visits and follow-ups
- 於患者留院/滴定階段開始給予援助，儘量減少患者住院日數  
During adaptation/titration phase in hospital, hence reducing the time of hospitalization
- 24小時緊急支援  
24-hours emergency service

- 緊密監察患者家居治療情況，定時與醫護人員跟進  
Close monitoring at home, constant to medical professionals
- 按需要進行遙距監察，按照處方調節治療方法  
Tele-monitoring to adjust the treatment as prescribed by physicians if needed
- 減低患者病情惡化及緊急送院治療風險  
Minimizing the possibility of exacerbation and the frequency of readmission to hospital due to acute attack



# 「維健」家居機械通氣治療計劃 Regain HMV Program

提供家用呼吸機及面罩，  
在醫院內安裝，以便進行：

Provide home ventilator and mask for  
hospital setup, in order to conduct:

氣壓滴定測試  
Pressure Titration test

面罩緊合度測試  
Mask fitting test

當病情由緊急轉趨穩定  
When the situation change  
from acute to stable

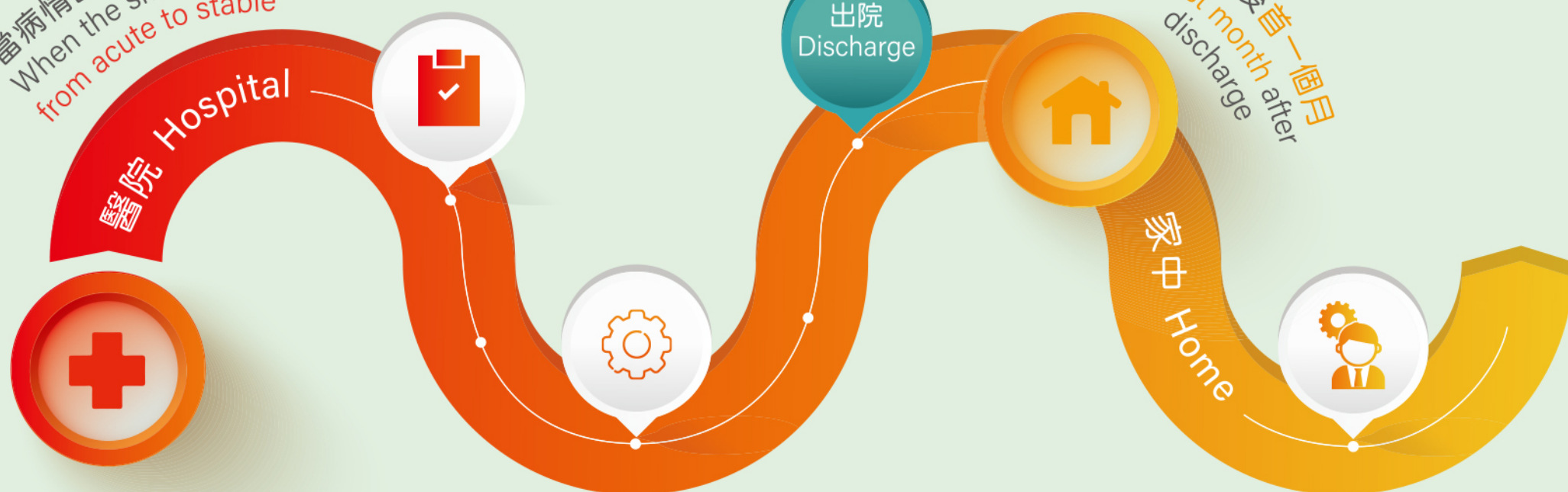

在醫院繼續使用我們提供的家用呼吸機及面罩，以便：  
Continue to use the home ventilator and mask provide by us, to:

適應器械通氣治療  
Adapt to the therapy

根據治療報告來設定呼吸機，確保最佳治療成效  
Adjust the ventilator setting according to  
the therapy compliance report

上門安裝、示範及教導  
Home setup, demonstration and education

協助患者適應家居器械通氣治療  
Assist patient to adapt to HMV

向患者及照顧者示範及教導如何操作  
及保養儀器  
Educate patient and caregiver on  
device operation and maintenance



# 「維健」家居機械通氣治療計劃

## Regain HMTV Program





呼吸機型號 Ventilators Models

型號 Model	 Trilogy Evo	 Trilogy 100	 EO-150	 Prisma Vent40	 BiPAP A40 Pro	 Prisma 30ST	 Lumis 150	 Dream- Station BiPAP ST
肺潮氣量 Lung Volume Mode	✓	✓	✗	✗	✗	✗	✗	✗
壓力模式 Pressure Mode	✓	✓	✓	✓	✓	✓	✓	✓
最大IPAP Max IPAP	60	50	50	40	40	30	30	30
兩組設定 Dual Prescription	✓	✓	✗	✓	✗	✗	✗	✗
侵入性 Invasive	✓	✓	✓	✓	✓	✗	✗	✗
非侵入性 Non-Invasive	✓	✓	✓	✓	✓	✓	✓	✓
被動漏氣端口回路 Leak Circuit (Passive Valve)	✓	✓	✓	✓	✓	✓	✓	✓
主動漏氣端口回路 Leak Circuit (Active Valve)	✓	✓	✗	✗	✗	✗	✗	✗
內置電池 Internal Battery (最高可用時數 Max. Usage Time)	✓ (15小時hours)	✓ (3小時hours)	✗	✓ (12小時hours)	✗	✗	✗	✗
警示鬧鐘 Alarm	✓	✓	✓	✓	✓	✓	✓	✓
使用時間 Usage	連續用 All day use	連續用 All day use	連續用 All day use	連續用 All day use	連續用 All day use	睡眠用 Sleep time	睡眠用 Sleep time	睡眠用 Sleep time
加熱濕潤器 Humidifier	外置式 External	外置式 External	外置式 External	外置式 External	嵌入式 Attachable	外置式 External	嵌入式 Attachable	外置式 External
尺寸 Dimension	16.5 x 28.6 x 24.5 cm	16.7 x 28.5 x 23.5 cm	24.5 x 14.5 x 10 cm	21.8 x 17.5 x 21.8 cm	21.6 x 19 x 11.5 cm	17 x 18 x 12.5 cm	11.6 x 25.5 x 15 cm	15.7 x 19.3 x 8.4 cm
重量 Weight	5.2 kg	5 kg	1.8 kg	2.5 kg	2.1 kg	1.4 kg	1.3 kg	1.33 kg
品牌 Brand								



# 喉管接駁方式 Available Circuit Option

## 被動式 Passive Circuit

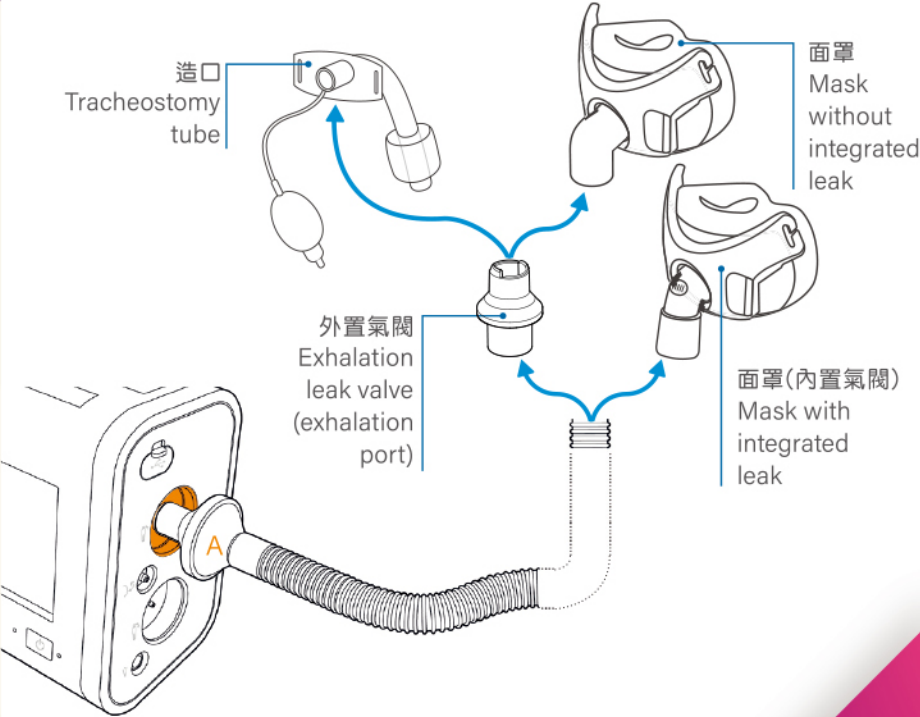

## 主動式 Active Circuit

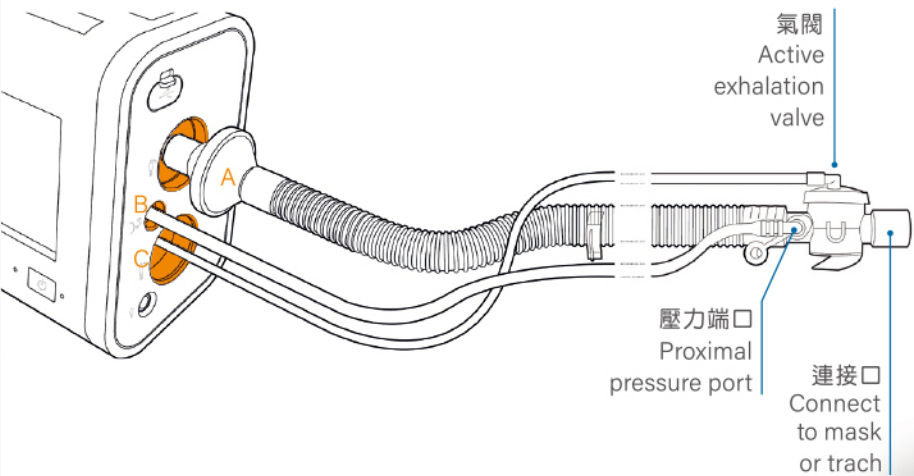

• 可加設流量感應器 Flow sensor is available

# 相關醫療儀器 Related Medical Devices

## 氧氣治療儀器 Devices for Oxygen Therapy

- 製氧機配合家居機械通氣治療，提供補充氧氣  
Oxygen concentrator applies with home mechanical ventilation when supplementary oxygen is needed
- 用作緊急支援，或於通氣治療暫停時提供流動氧氣  
For emergency back up or to provide ambulatory oxygen if needed
- 可使用電池驅動的手提製氧機為患者外出時提供可靠的流動氧氣  
Powered by battery, portable oxygen concentrator supply oxygen to patient outside home



## 血氧分析儀 Pulse Oximeters

- 即時量度患者脈搏及血氧度數  
To measure patient's instant pulse and oximetry level
- 座檯式血氧分析儀備有高低脈搏、血氧及脈搏警報功能  
Features include pulse rate (High/Low) and SpO<sub>2</sub> (High/Low) alarm function



## 手提型抽痰機 Portable Aspirator

- 獨有防溢設計確保衛生；設振膜系統防止分泌物倒流進入機內  
Unique design to prevent overflow, with a membrane system prevents secretions from entering the drive unit
- 輕巧、耐用、方便攜帶，內置電池備用時間長達80分鐘  
Portable, compact and durable equipped with internal battery for up to 80 minutes of usage





## 相關醫療儀器 Related Medical Devices

### 咳痰機 CoughAssist

- 可於醫院或家中使用，有效及無創地清除分泌物  
To provide an effective non-invasive way to remove secretion in hospital and at home
- 增加咳嗽時呼吸峰速流，保持患者氣道暢通，減少呼吸系統反覆感染機會  
Clinically proven to increase peak cough expiratory flows to keep patient's airways clear, and reduce recurrent respiratory infections
- 可調校振動程式以提高流動性  
Adjustable oscillation levels to enhance mobilization



EO70

### 拍痰背心 Afflovest

- 電池驅動以保持使用期間活動能力  
The battery-powered AffloVest is designed to increase therapy adherence through mobility
- 不同尺寸及長度調校，配合個人需要  
Custom fit size variations (XXS-XXL) and adjustable shoulder/chest straps to accommodate different patients' needs
- 可因應身體情況調節8段不同力度  
Patient-specific therapy with 8 anatomically positioned oscillating motors to create individual pressure waveforms



Afflovest

## 鼻罩/面罩選擇 Mask Selection

多款鼻罩及全面罩供選擇，以配合不同需要。  
Various masks are available to meet the different individual needs, ranging from oral nasal to full face mask.

### 醫院用 Hospital Use

#### AF 531 面罩 Oral Nasal Mask

- 頭帶設計易於調整角度及配戴  
Capstrap headgear provides an excellent fit and simple reapplication.
- 面罩軟墊減輕壓力，配戴舒適  
Comfortable seal minimizes facial pressure
- 公立醫院廣泛使用  
Widely using in public hospital



### 家居用 Home use

#### F20 矽膠面罩 Oral Nasal Silicone Mask

- 記憶海綿軟墊超級柔軟、獨特舒適  
Super soft and uniquely comfortable
- 透氣裝置可減少使用時產生的噪音  
Sound reduced while in use
- 磁力扣可輕鬆摘下或戴上面罩  
Magnetic clips is easy to on or off
- 夜間起床時無需除下面罩即可解開連接  
Disconnect without removing the mask



#### PerforMax 全面罩 Full Face Mask

- 面罩支架設矽膠軟墊，配戴更穩定舒服  
Overmolded soft silicone cushion permanently attached to the mask frame for secure and reliable fit
- 可選用標準喉接口或可轉換氣閥  
Capable to use standard elbow or interchangeable entrainment





## 港島區 Hong Kong Island

 **銅鑼灣店 Causeway Bay Branch**  2915 3388  9482 2116

軒尼詩道 489 號銅鑼灣廣場一期 21 樓 2102 室  
Shop 2102, 21/F, Causeway Bay Plaza Phase 1, 489 Hennessy Road

 星期一至六 Mon to Sat : 10:30 - 14:00; 15:00 - 19:00  
星期日及公眾假期 Sun & Public holidays: 10:30 - 14:00; 15:00 - 18:00



地圖 Map

 **中環店 Central Branch**  2522 6811  9482 0006

皇后大道中 33 號萬邦行 10 樓 1005 室  
Room 1005, 10/F, Melbourne Plaza, 33 Queen's Road Central

 星期一至五 Mon to Fri : 10:30 - 14:00; 15:00 - 19:00  
星期六、日及公眾假期 Sat, Sun & Public holidays: 休息 Closed



地圖 Map

## 九龍區 Kowloon

 **長沙灣店 Cheung Sha Wan Branch**  2332 3366  9438 1987

荔枝角道 777 號田氏企業中心 21 樓  
21/F, Tins Enterprises Centre, 777 Lai Chi Kok Road

 星期一至五 Mon to Fri : 09:30 - 13:00; 14:00 - 17:30  
星期六、日及公眾假期 Sat, Sun & Public holidays: 休息 Closed



地圖 Map

 **旺角店 Mongkok Branch**  2395 2300  9380 1513

彌敦道 688 號旺角中心第一座 19 樓 1920 室  
Room 1920, 19/F, Argyle Centre (Phase 1), 688 Nathan Road

 星期一至六 Mon to Sat : 10:30 - 14:00; 15:00 - 19:00  
星期日及公眾假期 Sun & Public holidays: 10:30 - 14:00; 15:00 - 18:00



地圖 Map

## 新界區 New Territories

 **沙田店 Shatin Branch**  2692 8666  9438 1986

沙田正街 3-9 號希爾頓中心商場 3 樓 46A 舖  
Shop 46A, 3/F, Hilton Plaza, 3-9 Shatin Centre Street

 星期一至六 Mon to Sat : 10:30 - 14:00; 15:00 - 19:00  
星期日及公眾假期 Sun & Public holidays: 10:30 - 14:00; 15:00 - 18:00



地圖 Map

## 澳門 Macau

 **澳門店 Macau Branch**  (853)2836 6039  (853)6666 3213

澳門南灣大馬路 371 號京澳大廈 5 樓 B 室  
Macua, Avenida da Praia Grande No. 371, Edf, Keng Ou 5/B

 星期一至五 Mon to Fri : 10:30 - 14:00; 15:00 - 19:00  
星期六 Sat : 10:30 - 14:00; 15:00 - 16:30  
星期日及公眾假期 Sun & Public holidays: 休息 Closed



地圖 Map

## 總公司 Head office

荔枝角道 777 號田氏企業中心 21 樓 21/F, Tins Enterprises Centre, 777 Lai Chi Kok Road

電話 Tel: 2332 3366 傳真 Fax: 2744 2313  
非辦公時間服務熱線 Emergency hotline: 8209 1111  
電郵 Email: celki.celkimed@airliquide.com  
網站 Website: www.celki.com



Facebook



MyCelkiShop